

BALL BEARINGS

BORE SIZE	TYPE	MATERIAL
1/8" TO 3/8"	SINGLE ROW - FLANGED PRECISION ABEC-1	52100 CHROME STEEL

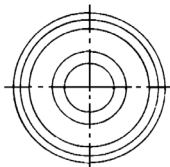

Unshielded
Oil Per Mil-L-6085

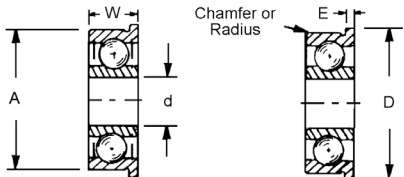

Shielded
Grease Per Mil-G-23827



STOCK NO.	d	D	W	A	SHIELD AND LUBE DATA	E	DYNAMIC LOAD (LBS) CAPACITY	STATIC LOAD (LBS) CAPACITY
B13-1 B13-2	.1250	.3750	.156 .156	.440	UNSHIELDED SHIELDED	.030	71	29
B13-4 B13-5	.1875	.5000	.156 .196	.565	UNSHIELDED SHIELDED	.042	139	60
B13-7 B13-8	.2500	.6250	.196 .196	.690	UNSHIELDED SHIELDED	.042	159	71
B13-10 B13-11	.3750	.8750	.281 .281	.969	UNSHIELDED SHIELDED	.062	451	219

See Section K (Reference Section) for Bearing Tolerances.

BORE SIZE	TYPE	MATERIAL
1/4" TO 1"	SINGLE ROW	316 STAINLESS STEEL RACEWAYS AND BALLS CAGE IS POLYMER

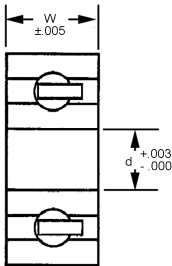
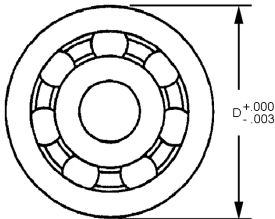

STOCK NO.	d	D	W	MAXIMUM RPM WITH NO LOAD	DYNAMIC LOAD (LBS) CAPACITY	STATIC LOAD (LBS) CAPACITY
B11-7-6	1/4	5/8	.196	2,352	89	51
B11-8-6	1/4	3/4	7/32	2,352	78	51
B11-9-6	1/4	3/4	9/32	2,352	78	51
B11-10-6	3/8	7/8	7/32	1,600	126	99
B11-11-6	3/8	7/8	9/32	1,600	126	99
B11-13-6	1/2	1-1/8	1/4	1,142	165	129
B11-14-6	5/8	1-1/8	1/4	1,142	165	129
B11-15-6	3/8	1-1/8	3/8	1,142	165	129
B11-16-6	1/2	1-1/8	3/8	1,142	165	129
B11-18-6	5/8	1-3/8	7/16	1,069	207	138
B11-19-6	3/4	1-5/8	5/16	840	234	156
B11-21-6	1	2	1/2	729	276	183

Load and speed calculations are for reference only. W.M. Berg recommends testing in actual environment to be encountered.